

Canine Parvovirus (CPV Ag) Rapid Test Cassette (Feces/Vomit)

DIRECTIONS FOR USE

1-Collect dog's feces or vomit with the swab stick from dog's anus or on the ground.

The amount of fecal swab as follows:

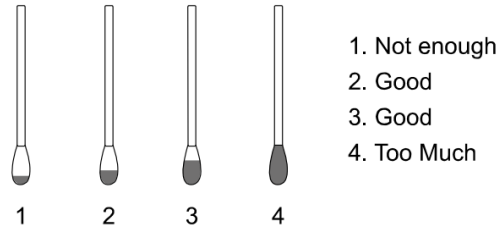

2- Insert the wet swab into the provided plastic tubes with buffer. Agitate it to assure good sample extraction.

3-Place the test cassette on a clean and level surface. Hold the dropper vertically and transfer 3 drops of extracted sample (approximately 120 µl) to the specimen well (S) of the test cassette, then start the timer. See illustration above.

4- Read the result at 5 minutes. Do not interpret results after 10 minutes

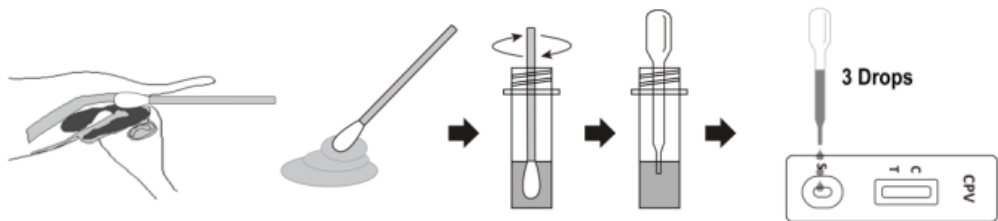

INTERPRETATION OF RESULTS

Positive: The presence of both C line and T line, regardless of T line being strong or faint.

Negative: Only clear C line appears.

Invalid: No colored line appears in C region, regardless of appearance.



PRECAUTIONS

- This package insert must be read completely before performing the test. Failure to follow directions in insert may yield inaccurate test results.
- For professional in vitro diagnostic use only.
- Do not use after expiration date.
- Wear protective clothing such as laboratory coats, disposable gloves, and eye protection when specimens are assayed.
- Please ensure that an appropriate quantity of sample volumes are used for testing. Too much or too little sample size may lead to deviation of results.
- The used test should be discarded according to local regulations.

STORAGE AND STABILITY

Store as packaged in the sealed pouch at room temperature or refrigerated (2-30°C). The test is stable through the expiration date printed on the sealed pouch. The test must remain in the sealed pouch until use.

DO NOT FREEZE. Do not use beyond the expiration date.